

outdoor

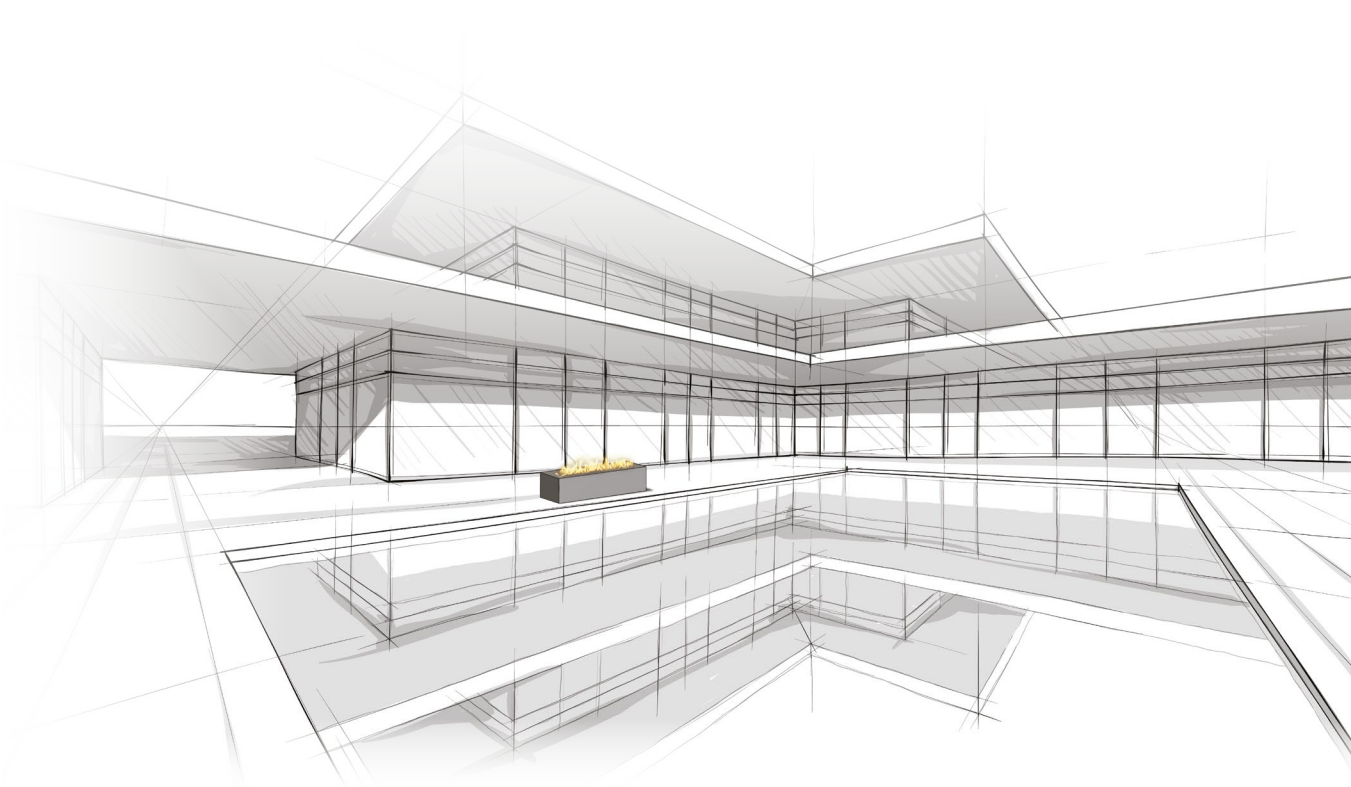

© PLANIKA | Ver. 15022017

www.PLANIKAfires.com

Rondo Commerce outdoor

Rondo Commerce

*An all-round user-friendly fireplace
Feel the pleasure of the moment*

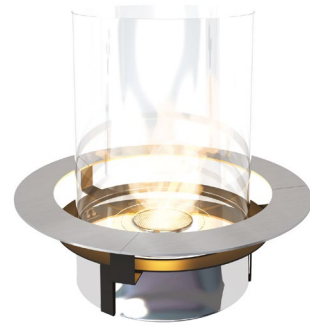

FEATURES:

- Commerce* Technology
- No smell / no ash / no smoke
- No chimney required
- For indoor / outdoor use
- Glass cylinder to safely enclose the flames
- Eco-friendly
- TÜV Certified

* Commerce Technology – Advanced technology which prevents fuel leakage due to absorbent ceramic fibres.



TECHNICAL DATA:

Capacity: 3 L / [US] 0,79 gal / [UK] 0,66 gal

Burning time: 6 - 10* h

Heat output: 2,5 kW / 8547 BTU

Net weight: 7 kg / 15,5 lbs

Finish:

CASING: brushed stainless steel, glass tube

BURNER: stainless steel

* Burning time depends on the amount of fuel poured in

DIMENSIONS:

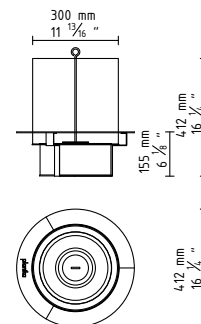

OUTDOOR INSTALLATION REQUIREMENTS:

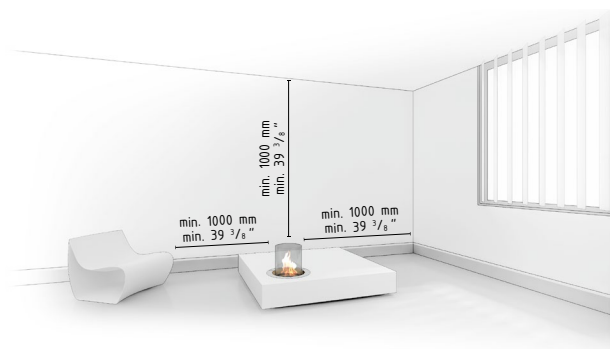

download **PRODUCT INSTRUCTION**

